 <p>Official Canadian Kennel Club Entry Form ENTRY FORM LURE COURSING FIELD TRIAL ENTRY</p> <p style="text-align: center;">Ontario Lure Coursing Assoc August 14th _____ August 15th _____</p>		
Entry Fees \$ _____ for Listing Fees \$ _____ Total Fees \$ _____		
Breed:	Stake:	Call Name:
Registered Name of Hound:		
Sex:	Place of Birth Canada <input type="checkbox"/> Elsewhere <input type="checkbox"/>	Date of Birth:
Registration Number: <input type="checkbox"/> CKC # - <input type="checkbox"/> ERN # - <input type="checkbox"/> PEN # - <input type="checkbox"/> Listed		
Breeder:		
Sire:		
Dam:		
Name of Actual Owner:		
Address:		
City, Province, Postal Code		
Phone Number:	<input type="checkbox"/> Check if this is Hound's first Trial in Canada	
Email:	<input type="checkbox"/> Please Separate my Hounds	
<p>I certify that I am the registered owner of the dog or that I am the authorized agent of the owner(s) whose name(s) I have entered above and accept full responsibility for all statements made in this entry. In considerations of the acceptance of this entry, I (we) agree to be bound by the rules and regulations of the Canadian Kennel Club and by any additional rules and regulations appearing in the premium list. I (we) personally assume all responsibility and liability for the action of this dog and further agree to hold the trial giving club blameless for disappearance, theft, injury, or otherwise. I (we) certify that the dog entered is not a hazard to persons or other dogs. I (we) certify that this dog is not DISQUALIFIED in ANY country.</p>		
Signature of Owner or Agent		

OFFICIAL CKC PREMIUM LIST



PRESENTS

Two CKC Lure Field Trials
August 14th & 15th, 2010
Icy Cold Estates
New Liskeard, Ontario

ROLL CALL

Saturday - August 14th 11:30
Sunday - August 15th 9:30

Entries: \$17.00 First Hound
\$12.00 Second Hound
\$10.00 Each Subsequent Hound / Same Owner
\$9.00 Listing Fee for dogs that do **NOT** have a CKC Number

Post Entries will not be accepted
Closing date for entries:
Thursday August 12th 10:00pm
ENTER VIA ENTRY-LINE
<https://www.entryline.com/>

Permission has been granted by the Canadian Kennel Club for holding these events under the Rules and Regulations of the CKC, Rules and Regulations of the CKC, 200 Ronson Drive, Suite 400, Etobicoke, M9W 5Z9

OLCA Executive:

President: Anton Osfolk
 Vice-President: Cathy Sanderson
 Secretary-Treasurer: HJ Dansereau

Field Trial Committee:

Field Trial Chairman: Everett Dansereau
 Field Trial Secretary: H-J Dansereau
 RR#2, 1733 Centre Rd
 Hamilton, ON L8N 2Z7
 Home Phone: (905) 659-1188
 Phone on Field: (705) 648-8484
 whippetgang@devonair.ca
 Field Clerks: Jeannie Martin, Fran Parke, Anne
 Hulley, Branka Bradick
 Huntsmasters: Jeannie Martin; Branka Bradick,
 Everett Dansereau
 Lure Operators: Cathy Sanderson, Anton Osfolk,
 Bill Phillips, Lucie Chauvette
 CKC Director: Richard Paquette
 CKC LC Rep. Karen Catt
 CKC CEO Joe Mauro

Eligibility: Only purebred Afghan Hounds, Basenji, Borzoi, Greyhounds, Ibizan Hounds, Irish Wolfhounds, Italian Greyhounds, Pharaoh Hounds, Salukis, Scottish Deerhounds and Whippets may be entered. All dogs must be one year of age or older on the day of the trial. Dogs not registered with the CKC must pay \$9.00 Listing Fee per trial / per day until CKC registration is obtained. Altered and neutered hounds may compete. **DOGS PRESENTLY DISQUALIFIED IN CANADA OR THE US ARE NOT ELIGIBLE!**

Conditions: Stakes will be split in any breed that has more than 24 dogs entered at the time of the draw. All dogs will run twice in braces or trios unless excused, dismissed or disqualified. Bitches in season or lame hounds will be excused, and any entry refunded if notice is given prior to roll call. Hounds not present at roll call will be scratched and entry fees not refunded. Handlers must use slip leads when starting their hounds. Muzzles may be used at owner's discretion. All hounds will be slipped from a standing start.

Official Canadian Kennel Club Entry Form		
ENTRY FORM LURE COURSING FIELD TRIAL ENTRY		
Ontario Lure Coursing Assoc August 14 th ___ August 15 th ___		
Entry Fees \$ ___ for Listing Fees \$ ___ Total Fees \$ ___		
Breed:	Stake:	Call Name:
Registered Name of Hound:		
Sex:	Place of Birth Canada <input type="checkbox"/> Elsewhere <input type="checkbox"/>	Date of Birth:
Registration Number: <input type="checkbox"/> CKC # - <input type="checkbox"/> ERN # - <input type="checkbox"/> PEN # - <input type="checkbox"/> Listed		
Breeder:		
Sire:		
Dam:		
Name of Actual Owner:		
Address:		
City, Province, Postal Code		
Phone Number:	<input type="checkbox"/> Check if this is Hound's first Trial in Canada	
Email:	<input type="checkbox"/> Please Separate my Hounds	
I certify that I am the registered owner of the dog or that I am the authorized agent of the owner(s) whose name(s) I have entered above and accept full responsibility for all statements made in this entry. In considerations of the acceptance of this entry, I (we) agree to be bound by the rules and regulations of the Canadian Kennel Club and by any additional rules and regulations appearing in the premium list. I (we) personally assume all responsibility and liability for the action of this dog and further agree to hold the trial giving club blameless for disappearance, theft, injury, or otherwise. I (we) certify that the dog entered is not a hazard to persons or other dogs. I (we) certify that this dog is not DISQUALIFIED in ANY country.		
Signature of Owner or Agent		

Course Plans

The club reserves the right to alter the course plan as required by weather and/or field conditions on the day of the trial.

Course will be reversed for finals and again for run-offs and BOB. BIF will be as per the Judges request. Course plans will be changed to suit field conditions.

Saturday – 1,000 Yards

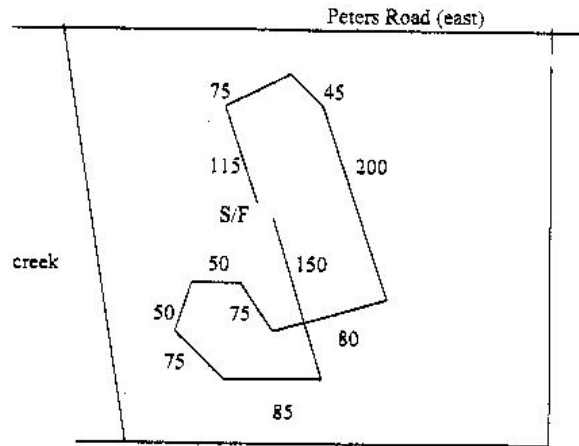

Sunday – 1,000 Yards

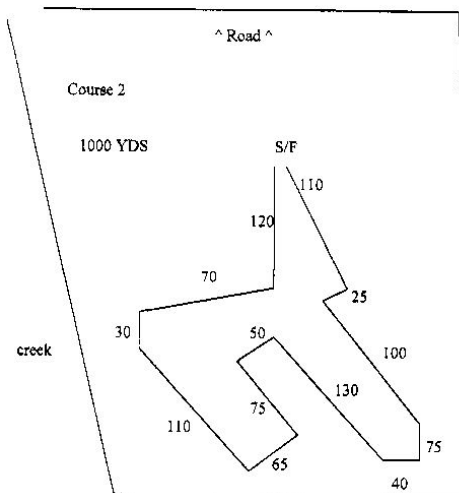

Equipment: A **Drag machine** with white and/or coloured plastic streamers will be used. Back up equipment will be on site.

MANDATORY CKC INFORMATION

"A judge officiating at a field trial under these rules and regulations (CKC) shall not be subject to indignities of any kind during the progress of the field trial. It shall be the duty and obligation of the club holding the field trial to see that this regulation is effectively carried out. The Field Trial Chairman shall promptly report to the Canadian Kennel Club any infringement of this regulation, and the Discipline Committee shall have the power to take such action as it deems fit on receipt of a report indicating that this regulation has been violated."

CHAMPIONSHIP POINTS IN REGULAR STAKES SHALL BE AWARDED ON THE BASIS OF THE FOLLOWING:

1 st Place	4 x # of hounds in Stake (Max. 40 points)
2 nd Place	3 x # of hounds in Stake (Max. 30 points)
3 rd Place	2 x # of hounds in Stake (Max. 20 points)
4 th Place	1 x # of hounds in Stake (Max. 10 points)
NBQ	No Points

TROPHIES AND AWARDS:

- Rosettes will be awarded for BIF, BOB and 1st through NBQ.
- Trophies will be awarded to all BOB and BIF
- In memory of SBIS Ch Devonair's Isabel, Can.Am FCh, CD, TT, CGC, the "Tail Trophy" will be awarded to the highest combined score over Saturday and Sunday to any whippet who has a combination any two AKC, ASFA or CKC Titles. The winner of the Trophy will receive a Keeper trophy and their name will be engraved on the perpetual trophy. This trophy will remain in the custody of Heather-Jean Dansereau and will only be retired upon the demise of OLCA.

STAKES OFFERED

Official: **OPEN**

Un-Official: **SINGLES** offered both days – Maximum 12 per Day AS PER ASFA RULES

COMBINED BEST IN FIELD Open to all Best of Breed Winners from both days

Judges:

Karen T. Catt: RR 2, 138410 Peters Rd, New Liskeard ON
Ian Davies: 5713 Etzler Road, Frederick, MD, 21702
Pat Wolfe: 733 Zephyr Road, RR#2, Uxbridge, ON L9P 1R2

JUDGING PANEL – SATURDAY August 14th

Afghan Hound	Ian Davies	Pat Wolfe
Basenji	Ian Davies	Pat Wolfe
Borzoi	Karen Catt	Ian Davies
Greyhound	Karen Catt	Ian Davies
Ibizan Hound	Ian Davies	Pat Wolfe
Irish Wolfhound	Ian Davies	Pat Wolfe
Italian Greyhound	Karen Catt	Ian Davies
Mixed	Karen Catt	Ian Davies
Pharaoh Hound	Ian Davies	Pat Wolfe
Saluki	Karen Catt	Ian Davies
Scottish Deerhound	Karen Catt	Ian Davies
Whippet	Karen Catt	Pat Wolfe
Singles	Ian Davies	

JUDGING PANEL – SUNDAY, August 15th

Afghan Hound	Karen Catt	Ian Davies
Basenji	Karen Catt	Ian Davies
Borzoi	Ian Davies	Pat Wolfe
Greyhound	Karen Catt	Ian Davies
Ibizan Hound	Ian Davies	Pat Wolfe
Irish Wolfhound	Karen Catt	Ian Davies
Italian Greyhound	Ian Davies	Pat Wolfe
Mixed	Ian Davies	Pat Wolfe
Pharaoh Hound	Karen Catt	Ian Davies
Saluki	Ian Davies	Pat Wolfe
Scottish Deerhound	Karen Catt	Ian Davies
Whippet	Karen Catt	Pat Wolfe
Singles	Karen Catt	

*POT LUCK DINNER
 SATURDAY
 BRING A DISH TO SHARE AND
 ENJOY THE EVENING*

IMPORTANT INFORMATION

- ✓ You need an up to date rabies certificate dated not less than 30 days but not more than three years to cross the border.
- ✓ You need a passport for each individual in your vehicle in order to return to the United States
- ✓ Our bank will not accept cheques marked "Payable in Canadian Funds". We suggest sending an American cheque and replacing it on the day of the trial with Cash.
- ✓ OLCA appreciates everyone's co-operation in keeping our site clean. There will be a \$5.00 fine for anyone caught not cleaning up after your hound.
- ✓ There will also be a \$5.00 fine for any loose dog interfering with a course in progress.
- ✓ **Flexi Leads and Electronic Collars are not permitted on the field.**

**Closing date for entries:
 Thursday August 12th**



**Use the entry line for on line entries
 Important: Entries taken until: 6:00 pm on day of
 closing This is a privately owned business and
 charges a fee for this service**

ENTRIES WILL NOT BE ACKNOWLEDGED

**For more information watch OLCA's web site at
www.olca.csfa.info**

**YOU ONLY NEED TO SUBMIT ONE ENTRY FORM FOR THE
 WHOLE WEEKEND, NOT ONE FOR EACH DAY**